



13 Maple Close, Shaw

£199,950

🛏️ 3 🍽️ 1 🚗 1



- Mid Town House
- Three Double Bedrooms
- Superb Lounge Media Wall
- Large Kitchen/Dining Room
- Wonderful Bathroom
- Double Driveway
- South Facing Garden
- EPC:



Offered for sale is this well appointed middle town house located in a tucked away Cul-de-sac in Shaw/Crompton.

Accommodation comprising: Entrance hallway, lounge with a gorgeous media wall and a good size kitchen/dining room. To the first floor there are three double bedrooms and a bathroom.

Externally to the front is a double driveway and to the rear a paved garden with raised decking.

Quality local schools within a short walk as is the local Metro tram stop.

Contact us today to arrange a viewing on what could be your next home.

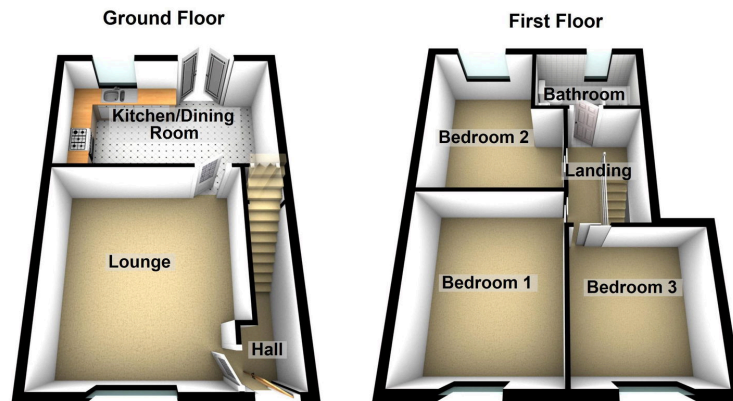

Chadderton Office

509 Middleton Road,
Chadderton, Oldham,
OL9 9SH

chadderton@kirkham-property.co.uk
t: 0161 626 5688